

6.76 mm Thick and clear without shade band Laminated safety glass for wind shield application. the testing of glass as per IS:2553 (part 2) - 1992. Edge grinding as per SAE J6738 Type 4. Light transmission Min 70%. Glass thickness outer layer 3mm+Laminated 0.76mm+inner layre 3mm with  $\pm 0.2$ mm.

## Cabin Sealing /gaskets

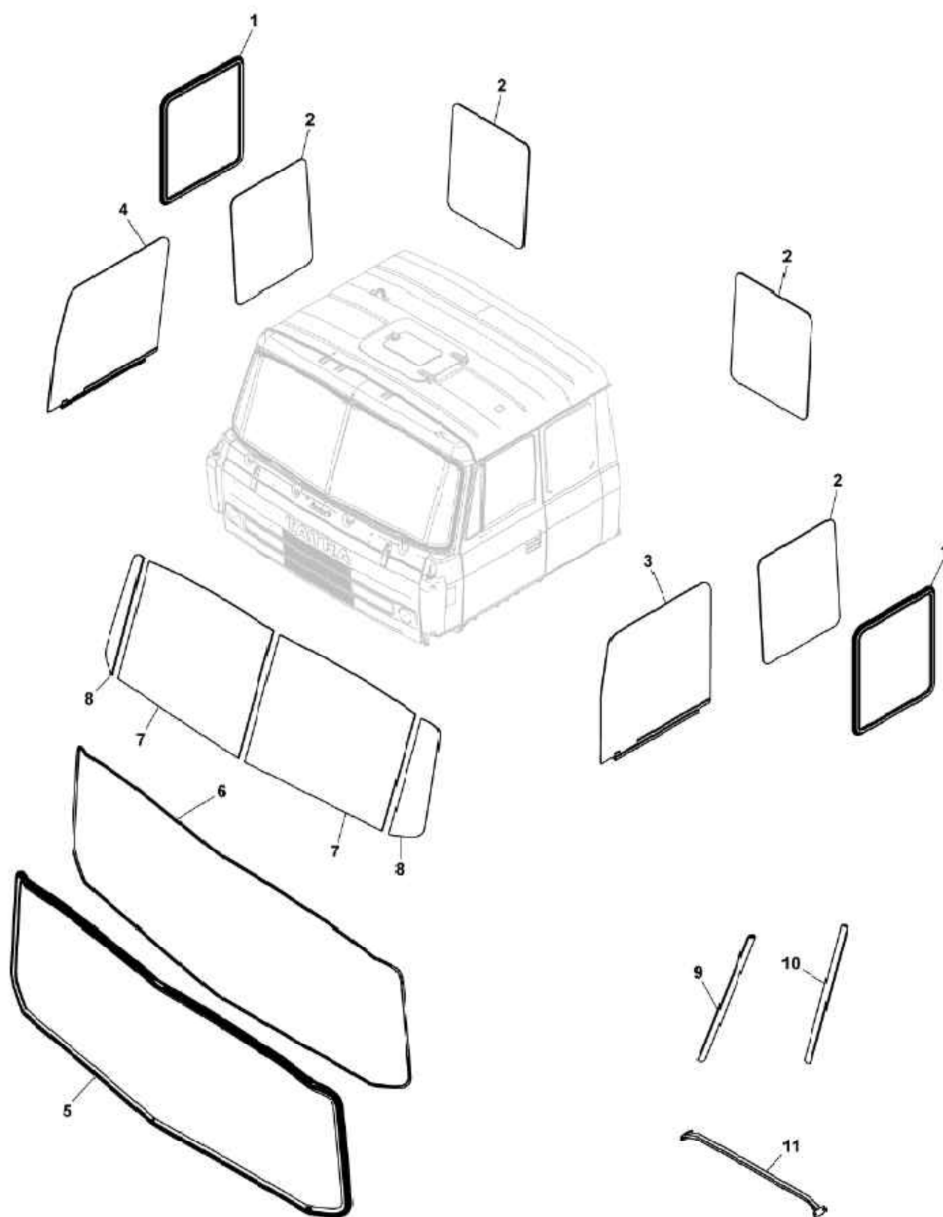

*Handwritten signature*

11	Inner Section	1
10	Glass Gasket 655 mm	2
9	Gasket 730 mm	1
8	Side Glass	2
7	Front Glass	2
6	Rubber Wedge 5870mm	1
5	Front Wind Shield 5720mm	1
4	Bar C/W Glass, Left	1
3	Bar C/W Glass, Right	1
2	Side Glass	4
1	Glass Gasket 1960mm	1
SL NO	DESCRIPTION	QTY

